

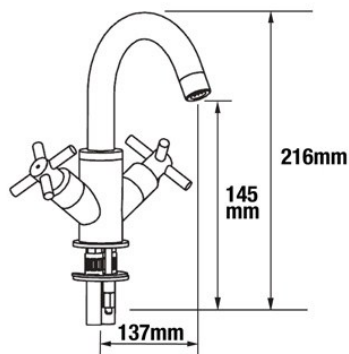

**Pegler Yorkshire**  
connect & control

## Xia Monobloc Basin Mixer

### Monobloc Basin Mixer



| Code   | Description                 | Dimensions |
|--------|-----------------------------|------------|
| 4K8001 | XIA CP MONOBLOC BASIN MIXER | see image  |

*Pegler Yorkshire reserve the right to change specifications*

### 10 Year Guarantee

#### Luxury Taps and Mixers

#### Pegler Yorkshire Customcare 10 Year Guarantee - Terms and Conditions

Product are subject to a 10 year guarantee that is between Pegler Yorkshire and the final purchaser of the product.

The guarantee is subject to proof of purchase being supplied.

This guarantee does not affect any statutory rights the consumer may have in law.

The guarantee covers manufacturing or material defects and does not cover parts subject to normal wear and tear.

Finishes other than chrome are covered for a period of 3 years only and the guarantee on the finish is subject to the cleaning instructions being followed.

The guarantee is not applicable where the product is fitted contrary to the conditions in the fitting instructions.

Abusive behaviour and accidental damage to the product are not covered by this guarantee.

The extent of this liability is limited to the cost of the replacement of the defective item and not to fitting or consequential damages.

| Description          | Minimum Operating Pressure (bar) | Maximum Cold Working Pressure (bar) | Maximum Hot Working Pressure (bar)            |
|----------------------|----------------------------------|-------------------------------------|---|
| Monobloc Basin Mixer | 0.2 bar                          | 6.0 bar at temperatures up to 85oC  | Not Suitable for Maximum Hot Working Pressure |

### Care

To maintain the surface finish, simply wipe occasionally with a mild detergent on a soft damp cloth. Dry, using a soft cloth. Never use abrasive cleaners or chemical household cleaners and avoid contact with concentrated bleach.

### Maintenance

No regular maintenance is required for this product.

In case of complete replacement Pegler recommend service valves should be fitted to the supply inlets.

For any further help or replacement parts please contact the Service Support Team on 0800 1560050.

### Regulations

It is important to ensure that the water supplies to your taps and mixers are connected in accordance with the water regulations (WRAS) requirements and good plumbing practice.

It is Pegler's recommendation and good plumbing practice that the supplies of hot and cold water to the mixer should be at equal (balanced) pressures in order to provide a consistent flow. Supplies should be from a common source, either mains or tank fed. If supplies are not equal pressures then non return valves should be fitted.

| Component | Material |
|-----------|----------|
|-----------|----------|

|                     |                         |
|---------------------|-------------------------|
| Body                | Brass with Chrome Plate |
| Headwork            | Ceramic Disc            |
| Pop up rod/knob     | Brass with Chrome Plate |
| Clamping plate/stud | Brass                   |
| Clamping stud       | Stainless Steel         |

### Monobloc Basin Mixer

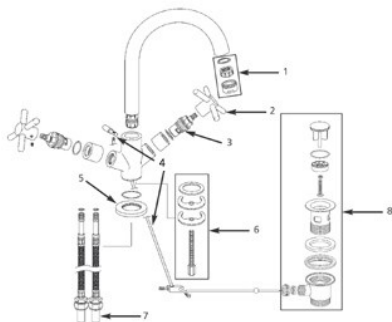

| 1         |                                     |        |               |            |            |                  |
|-----------|-------------------------------------|--------|---------------|------------|------------|------------------|
| Spare Key | Description                         | Code   | Barcode       | Date From  | Date To    | Price (£) ex VAT |
| 1         | FS57CP FLOW STRAIGHTENER CHROME     | 854068 | 5013866064654 | 01/01/1900 | To Current | £9.50            |
| 2         |                                     |        |               |            |            |                  |
| Spare Key | Description                         | Code   | Barcode       | Date From  | Date To    | Price (£) ex VAT |
| 2         | HD76CP HANDLE CHROME                | 854053 | 5013866064500 | 01/01/1900 | To Current | £37.28           |
| 3         |                                     |        |               |            |            |                  |
| Spare Key | Description                         | Code   | Barcode       | Date From  | Date To    | Price (£) ex VAT |
| 3         | HK66 HEADWORK CARTRIDGE             | 850910 | 5013866063091 | 01/01/1900 | To Current | £49.00           |
| 4         |                                     |        |               |            |            |                  |
| Spare Key | Description                         | Code   | Barcode       | Date From  | Date To    | Price (£) ex VAT |
| 4         | PUR22CP POP UP ROD & KNOB CHROME    | 854458 | 5013866083976 | 01/01/1900 | To Current | £18.03           |
| 5         |                                     |        |               |            |            |                  |
| Spare Key | Description                         | Code   | Barcode       | Date From  | Date To    | Price (£) ex VAT |
| 5         | FL22CP BASE RING CHROME             | 854075 | 5013866064722 | 01/01/1900 | To Current | £12.52           |
| 6         |                                     |        |               |            |            |                  |
| Spare Key | Description                         | Code   | Barcode       | Date From  | Date To    | Price (£) ex VAT |
| 6         | FP41 FIXING PACK                    | 854064 | 5013866064616 | 01/01/1900 | To Current | £6.25            |
| 7         |                                     |        |               |            |            |                  |
| Spare Key | Description                         | Code   | Barcode       | Date From  | Date To    | Price (£) ex VAT |
| 7         | IT10 INLET TAILS PAIR               | 854056 | 5013866064531 | 01/01/1900 | To Current | £24.66           |
| 8         |                                     |        |               |            |            |                  |
| Spare Key | Description                         | Code   | Barcode       | Date From  | Date To    | Price (£) ex VAT |
| 8         | PUW2CP POP UP WASTE COMPLETE CHROME | 854067 | 5013866064647 | 01/01/1900 | To Current | £24.99           |

Your Guide to the installation, care  
and maintenance of

# Xia

## Luxury Bathroom Fittings

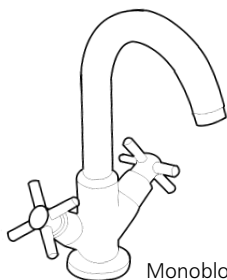

4K8001 Xia  
Monobloc Basin Mixer

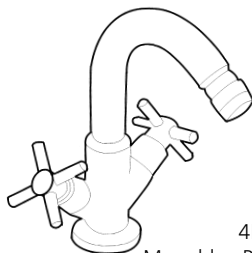

4K8002 Xia  
Monobloc Bidet Mixer

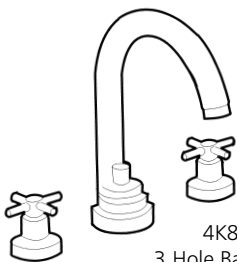

4K8003 Xia  
3 Hole Bath Filler

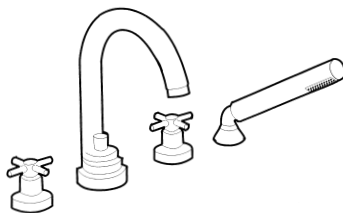

4K8004 Xia  
4 Hole Bath Shower Mixer

francis  
pegler

Pegler Limited, St. Catherine's Avenue, Doncaster, South Yorkshire. DN4 8DF  
Telephone: 01302 560560 Fax: 01302 560109

## Before Starting

Thoroughly flush all pipework.

It is our recommendation and good plumbing practice that water supplies to the mixers should have equal pressure.

It is necessary to fit these products in accordance with WRAS water supply (water fittings) 1999 and in Scotland water bylaws 2000.

## Pre-installation checks

1. Ensure that there is sufficient space to install the product without hampering its operation. Ensure that when fitting bath products that the product will not foul the overflow. When fitting in a corner position make sure there is sufficient clearance for the use of handles.
2. Ensure that the outlet will protrude sufficiently into the bath and will clear any obstructions.
3. Water supply for these products should be within range:

|                             |                          |
|-----------------------------|--------------------------|
| Basin deck mounted products | 0.1 bar - 6.0 bar static |
| Bath deck mounted products  | 0.4 bar - 6.0 bar static |
| Bath Shower Mixer           | 0.4 bar - 4.0 bar        |

## Installation

### Basin and Bidet Mixers

1. Ensuring the O rings are in place screw the tails into the body.
2. Screw clamping studs into body.
3. Unscrew pop-up knob, insert rod from underside of body. Locate pop-up knob into slot, align threads and tighten.
4. Place washer and flange onto body and put onto ware.
5. Place clamping plate and clamping washer onto clamping studs.
6. Attach clamping nuts to the studs and tighten up to ware.

### To fit pop-up waste

1. Remove plastic cover.
2. Unscrew flange portion and fit to ware.
3. The shaped sealing should be under flange.
4. Offer up lower portion to the ware ensuring that the lower sealing gasket is fitted between ware and waste.
5. Tighten firmly ensuring that the horizontal rod faces the back of the ware.
6. Lift the vertical rod upwards pass through the hole in the connecting clip. position the vertical rod to its lowest position.

7. Place the plug in the waste and adjust the connecting clip position so that the plug is open when the vertical rod is at its lowest then tighten the connecting clip screws.
8. Attach taps flexible tails to water supply and check.

### **Three hole bath filler and four hole bath shower mixer**

Before starting ensure that the space between the bath and the mixer is clear and that the waste and overflow you intend to fit will not foul on the mixer body. Leave room for allen key for spout fixing. Screw the tails into the mixer.

1. Remove spout from the assembly by loosening the grub screw in the back of the mixer.
2. Place the mixer body through the ware and tighten the centre body with washers and backnuts provided.
3. The spout can be replaced now or left until completion.
4. Check that the sidecocks are positioned to allow the handle position to your requirements. This may in some cases mean that the flexible hose has to go around the sidecock in these cases check you have sufficient length of flexible hose.
5. Fit the sidecocks through the ware and tighten to the ware using the washers and backnuts provided.
6. Fit the sidecocks to the centre body using the flexible hoses and washers supplied.
7. Set distance to the required height screwing the top cover onto the sidecock ensuring the top cover does not leave any excess thread showing.
8. Fit handle and tighten grub screw.

### **If fitting a bath shower mixer go to the next section before proceeding**

9. Using good plumbing practice attach to water supply.
10. Check for leaks.

### **Bath shower mixer**

1. Fit the shower handset holder to the ware ensuring that it is positioned so that the flexible hose can reach from the centre body to the normal position of use without being stretched.
2. Attach the flexible hose to the centre body.
3. Thread up through the holder and affix to the handset.
4. Clamp the weight over the hose at a point which ensures that the hose is not stretched from the centre body.

## CARE AND MAINTENANCE

To maintain the surface simply wipe occasionally with a non abrasive detergent on a soft damp cloth and dry using a soft cloth.

Never use abrasive household cleaners or chemical products.

Avoid contact with concentrated bleach.

Pegler products are manufactured to the highest standards and should require little or no maintenance.

In the unlikely event of any spare part requirements. Please contact your nearest stockist or

Pegler Limited, St Catherine's Avenue, Doncaster,  
South Yorkshire. DN4 8DF

Or contact us on  
the following  
numbers:

Northern Team

Tel: 0870 1200281

Fax: 01302 560108

Southern Team

Tel: 0870 1200282

Fax: 01302 560458

Western Team

Tel: 0870 1200283

Fax: 01302 560109

 Northern Area  
Western Area  
Southern Area

